

## Accessories

### Handwheels HR

2-spoke handwheel of chill-cast light aluminium RN 9501, polished, with rotating conical handle of black plastic. Bore keyed to DIN 6885.

Note: Hand wheels must not be mounted on the drive shaft when not operating the screw jack. Separate storage is required!

Manual clamping plate KP available upon request.

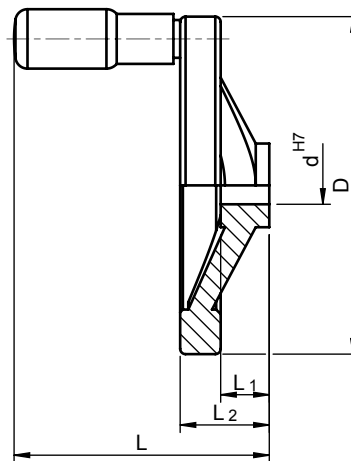

Dimensions						
Size	Type/Size	Dimensions [mm]				
		d	D	L	L <sub>1</sub>	L <sub>2</sub>
MULI 0	HR 80	9	80	81,5	16	29
	HR 100		100	85,5	17	33
	HR 125		125	94,5	18	36
MULI 1	HR 80	10	80	81,5	16	29
	HR 100		100	85,5	17	33
	HR 125		125	94,5	18	36
MULI 2	HR 80	14	80	81,5	16	29
	HR 100		100	85,5	17	33
	HR 125		125	94,5	18	36
	HR 140		140	97,5	19	39
	HR 160		160	107,5	20	40
MULI 3	HR 140	16	140	97,5	19	39
	HR 160		160	107,5	20	40
	HR 200		200	127,5	24	45
MULI 4	HR 200	20	200	127,5	24	45
	HR 250		250	154,5	28	50
MULI 5 / JUMBO 1	HR 250	25	250	154,5	28	50